

Algebra

MATH 101 – 5 Credits/\$400 – November 2010



Class Description:

This class offers a review of pre-algebra and algebra skills in preparation for Math 111. Topics to be covered include order of operations, factoring, inequalities, polynomials, exponents, scientific notation, algebraic equations, systems of equations, and quadratic functions. Students will gain an understanding of these mathematical tools in the context of practical problem solving.

Location:

**Building Industry Association of
Whatcom County
1650 Baker Creek Place
Bellingham, WA 98226**

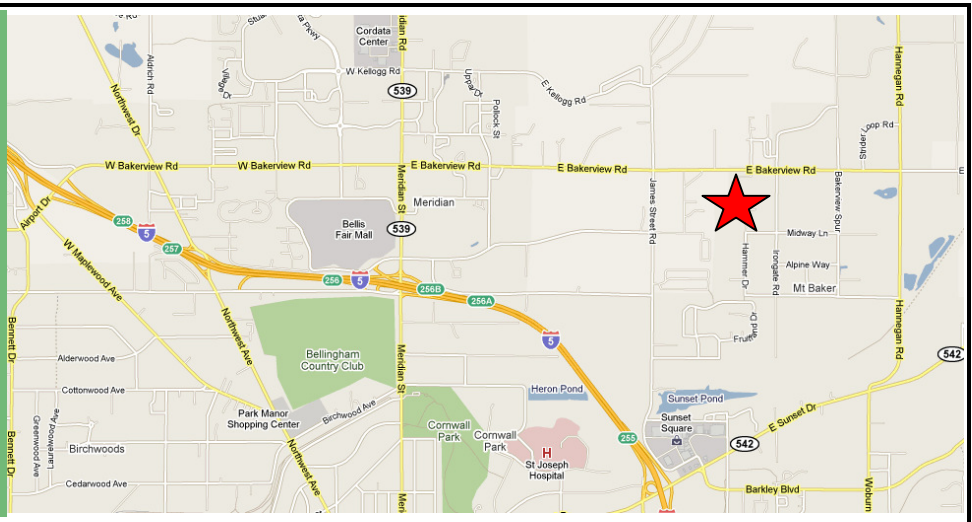

Dates and Times:

The class is scheduled to run on **Monday and Wednesday evenings at 6:00-9:00 PM from November 1st to December 15th**. This provides (14) evening classes to cover the course material. Please see the Class Calendar on the third page for course material.

Tuition and Registration:

Tuition for this class is \$400. Tuition must be paid before the class begins. Program enrolled students have seniority for this class and should register online three-weeks before the class begins. Continuing education students may begin registering online two-weeks before the class begins. Students may also send class registrations by mail to the following address:

**Washington Engineering Institute
Registration Office
PO Box 483
Custer WA 98240**

Class Materials Provided:

- Various handouts and lecture notes
- Text book: McDougal Littell Pre-Algebra, 2005. Text books are the property of Washington Engineering Institute and are on loan to you for the duration of the class. A \$30 fee is required for a lost or damaged book.

Class Materials Provided by the Student:

- 3-Ring Binder
- Scientific Calculator
- Engineering Paper

Instructor

Marjorie Bills

Experience: 10 years of experience in the private civil engineering industry performing stormwater analysis, design, permitting, and technical report writing. Ms. Bills currently has a consulting business with a focus on stormwater analysis and design services.

Education: Bachelor of Science in Mathematics, Western Washington University
Associates of Science in Civil Engineering Technology, Bellingham Technical College
Associates of Science in Pre-Engineering, Shoreline Community College

Class Format:

Each class period will offer a formal lecture and then time for students to work on problems. For each hour of class time, there will be a 10-minute break. It is anticipated that extra sessions for studying and/or tutoring may be needed. The instructor will discuss tutoring and study session options at the first class night.

Final Exam and Grades:

Grades will be determined by attendance (15%), Homework (20%), 4 quizzes (40%) and a final exam (25%).

November / December 2010 – Algebra – MATH 101

Monday		Tuesday	Wednesday		Thursday	Friday	Saturday	Sunday
1	6:00-9:00 PM	2	3	6:00-9:00 PM	4	5	6	7
Ch. 1 The number line, variables, order of operations, the coordinate plane			Ch. 2 Converting units, solving equations					
8	6:00-9:00 PM	9	10	6:00-9:00 PM	11	12	13	14
Ch. 3 Solving equations and inequalities using algebra and graphing			QUIZ 1 (30 min.) Ch. 4 Factoring, exponents, scientific notation					
15	6:00-9:00 PM	16	17	6:00-9:00 PM	18	19	20	21
Ch. 5 Rational numbers and equations			Ch. 6 Ratios, proportions, similar triangles					
22	6:00-9:00 PM	23	24	6:00-9:00 PM	25	26	27	28
QUIZ 2 (30 min.) Ch. 7 Percents, decimals, and fractions Simple and compound interest			Ch. 8 Slope-intercept equation of a line, definition of a function, graphing functions, systems of linear equations					
29	6:00-9:00 PM	30	1	6:00-9:00 PM	2	3	4	5
QUIZ 3 (30 min.) Ch. 9 Right Triangles Pythagorean Theorem Distance Formula			Ch. 10 Areas and volumes of geometric planes and solids					
6	6:00-9:00 PM	7	8	6:00-9:00 PM	9	10	11	12
QUIZ 4 (30 min.) Ch. 12 Polynomials Multiplying binomials			Ch. 12 Quadratic Functions Graphing					
13	6:00-9:00 PM	14	15	6:00-9:00 PM	16	17	18	19
Review			FINAL					



PO Box 483
 Custer WA 98240
admin@weiedu.org
 (360) 739-1428

Class Registration Form 2010 v2.0

Returning students with a Student ID do not need to fill out the gray portions of this form.

Name	
Address	
Phone	
Email	

Class Requested	MATH 101 – Algebra
Class Month / Date	November / December 2010

WAC 490-105-160 – State Licensed School Reporting Requirements:

Student ID #		
SSN #		
Date of Birth		
Gender		
Disability	<input type="checkbox"/> Yes <input type="checkbox"/> No	
Race	<input type="checkbox"/> American Indian or Alaska Native <input type="checkbox"/> Asian <input type="checkbox"/> Black/African American <input type="checkbox"/> Hawaiian Native or Pacific Islander <input type="checkbox"/> Hispanic <input type="checkbox"/> White/Caucasian <input type="checkbox"/> Multi-racial <input type="checkbox"/> Other	
Prior Education	<input type="checkbox"/> Less than high school graduation <input type="checkbox"/> GED <input type="checkbox"/> High School Graduate <input type="checkbox"/> Post H.S., no degree or certificate <input type="checkbox"/> Associate Degree <input type="checkbox"/> Bachelor Degree <input type="checkbox"/> Master or Doctorate Degree	GED Year _____ Graduation Year _____ Graduation Year _____ Graduation Year _____ Graduation Year _____
Name of Last School Attended		

Student Signature

Date