

CAD II

CAD 112 – 5 Credits – May/June 2011



Class Description:

This is an intermediate level CAD class. Students will learn 3D drawing with AutoCAD software by conducting various projects. Course topics include: images, wireframes modeling, surface modeling, and solid modeling, rendering, image draping, and 3D texture mapping.

Location:

**Building Industry Association of
Whatcom County
1650 Baker Creek Place
Bellingham, WA 98226**

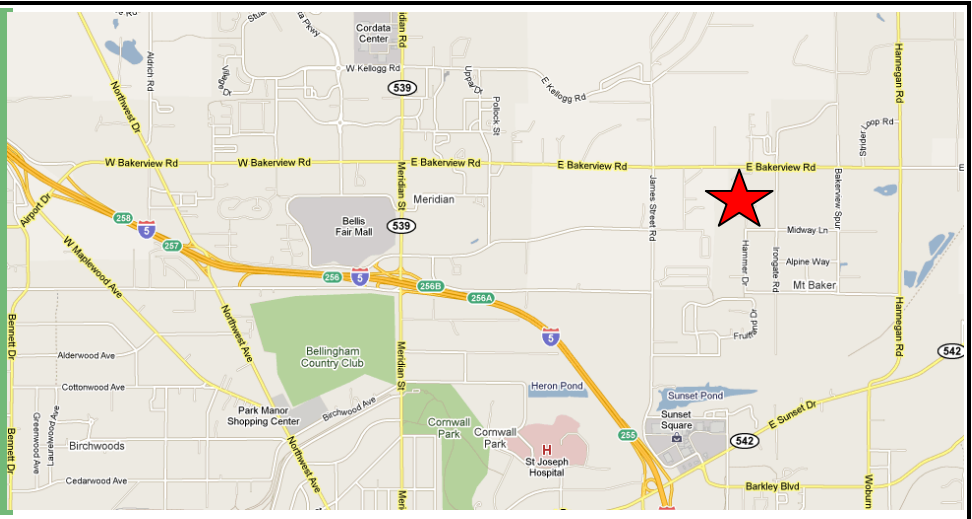

Dates and Times:

The class is scheduled to run on **Wednesday evenings at 6:00-9:00 PM from May 4th to June 22nd**. This provides a total of (8) evening classes to cover the course material. Please see the Class Calendar on the last page.

Tuition and Registration:

Tuition for this class is \$400. Tuition must be paid before the class begins. Program enrolled students have seniority for this class and should register online three-weeks before the class begins. Continuing education students may begin registering online two-weeks before the class begins. Students may also send class registrations by mail to the following address:

**Washington Engineering Institute
Registration Office
PO Box 483
Custer WA 98240**

School Provided Materials:

- **Lecture Notes:** The school provides lecture handouts as needed.
- **Temporary School Laptop:** Enrolled students should obtain their own laptop and install AutoCAD 2010/2011 as soon as possible. However, you may temporarily borrow a school laptop during lecture times, but you will not have it to study at home. Therefore, you should obtain a laptop as soon as possible. Please contact dbren@weiedu.org if you need to borrow a school laptop temporarily during lectures.

Student Provided Materials:

- **Personal Laptop:** Program enrolled students are required to have a laptop in order to conduct their program. Enrolled students should obtain their own laptop and install AutoCAD 2010/2011 as soon as possible.
- **AutoCAD 2010/2011 Student Download:** Students should download and license AutoCAD 2010/2011 to their laptop as part of the coursework for the class, through the Autodesk Education Community. Your instructor will provide a special link for you to download and license AutoCAD on the first night of class.3 Ring Binder, calculator, engineer calculations pad (green sheets), and small straight edge for linework.

Instructor

Dave C. Bren, PE, MSCE Civil Engineering Technology Instructor

Experience: 15 years of experience in the public and private civil engineering industry. Most recent experience was as the Assistant Public Works Director for the City of Blaine. Mr. Bren established and taught the Civil Engineering Technology program at Bellingham Technical College from 1997-2006 while continuing to consult in the industry.

Registration: Professional Engineer
State of Washington License

Education: Master of Science in Civil Engineering
University of Washington

Bachelor of Science in Civil Engineering
University of Washington

Format:

Class Structure: Evenings will typically run in one-hour blocks as follows:

6:00 PM – Class setup and first hour
6:50 PM – Break
7:00 PM – Class
7:50 PM – Break
8:00 PM – Class last hour

Final Exam and Grades:

Grades will be determined by attendance character (30%) and class projects (70%). The Instructor holds sole authority to issue grades and shall issue grades based on a 4.0 schedule as follows.

Grading legend

4.0	A
3.7	A-
3.3	B+
3.0	B
2.7	B-

2.4	C+
2.0	C
1.7	C-
1.3	D+
1.0	D
0.7	D-

AU	Class audited with no grade earned
EXP	Experiential credit granted per policy
EDU	Prior education credit granted per policy
I	Incomplete – Instructor Allows Extra Time to Complete
W	Withdrawn from class

May / June 2011 – CAD 2

Monday	Tuesday	Wednesday	Thursday	Friday	Saturday	Sunday
2	3	4 3D Drawing Basics 6:00 – 9:00 PM Coordinates & Display Wireframes P1: 3D House/Structure	5	6	7 MS & PS Plotting Review 9:30AM – NOON Review MS Plotting Review PS Plotting Titleblock Preparation	8
9	10	11 3D Drawing – Surface and Terrain Modeling 6:00 – 9:00 PM Surface Modeling Solid Modeling P2: 3D House Surfaces, Terrain, and Trees	12	13	14	15
16	17	18 External References 6:00 – 9:00 PM Creating and Using Xrefs File formatting standards Xref Link Repair	19	20	21	22
23	24	25 Images and Blocks 6:00 – 9:00 PM Aerial Images Review Design Center and Symbol Blocks P3: Whiskey Creek Water Bodies Aerial Analysis	26	27	28	29
30	31	1 Pen Assignments 6:00 – 9:00 PM Review Layouts, Viewports, and Paperspace Plotting Pen Assignments and CTB / Color Table Files P4: Publishing with Pen Assignments	2	3	4 CAD LAB 9:30AM – NOON Open CAD Lab Day Work on projects with teams	5
6	7	8 PGP and LIN files 6:00 – 9:00 PM PGP / Alias Customization LIN / Linetype Customization P5: Making New Linetypes	9	10	11	12
13	14	15 Script Files 6:00 – 9:00 PM Creating & Running Script Files Creating & Running an AutoCAD Slide Show P6: Making your own CAD Slideshow with Script	16	17	18	19
20	21	22 Final Exam 6:00 – 9:00 PM Toolbar & Button Customization Ribbon Bar Review P7: Making your own Custom Toolbar and Buttons	23	24	25	26

Washington Engineering Institute, 4055 Hammer Drive Suite B2, Bellingham WA 98226

website: www.weiedu.org

email: admin@weiedu.org

phone: (360) 739-1428



PO Box 483
 Custer WA 98240
admin@weiedu.org
 (360) 739-1428

Class Registration Form 2010 v2.0

Returning students with a Student ID do not need to fill out the gray portions of this form.

Name	
Address	
Phone	
Email	

Class Requested	CAD 112 – CAD II
Class Month / Date	May/June 2011

WAC 490-105-160 – State Licensed School Reporting Requirements:

Student ID #		
SSN #		
Date of Birth		
Gender		
Disability	<input type="checkbox"/> Yes <input type="checkbox"/> No	
Race	<input type="checkbox"/> American Indian or Alaska Native <input type="checkbox"/> Asian <input type="checkbox"/> Black/African American <input type="checkbox"/> Hawaiian Native or Pacific Islander <input type="checkbox"/> Hispanic <input type="checkbox"/> White/Caucasian <input type="checkbox"/> Multi-racial <input type="checkbox"/> Other	
Prior Education	<input type="checkbox"/> Less than high school graduation <input type="checkbox"/> GED <input type="checkbox"/> High School Graduate <input type="checkbox"/> Post H.S., no degree or certificate <input type="checkbox"/> Associate Degree <input type="checkbox"/> Bachelor Degree <input type="checkbox"/> Master or Doctorate Degree	GED Year _____ Graduation Year _____ Graduation Year _____ Graduation Year _____ Graduation Year _____
Name of Last School Attended		

Student Signature

Date